

Windload Charts | AFG7251 Series

A = 16 P.S.F. (766 Pa) Description: 2 1/2" X 7 1/4" Offset Glazed For 1" Glass
 B = 20 P.S.F. (958 Pa) Function: Window Wall
 C = 25 P.S.F. (1197 Pa) Detail: Design Criteria
 D = 30 P.S.F. (1436 Pa) Scale: N.T.S.
 E = 40 P.S.F. (1915 Pa)

SHEET 1 OF 3

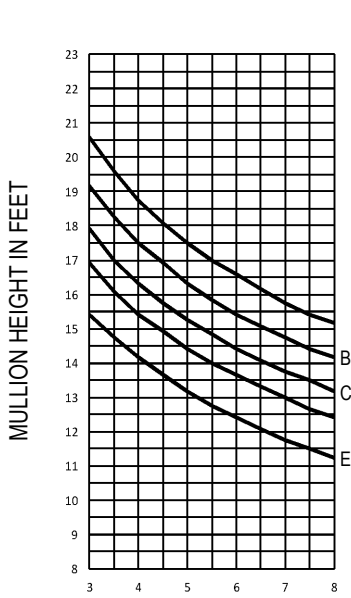

$I = 15.029 \text{ IN}^4$
 $S = 4.086 \text{ IN}^3$

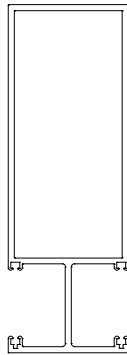

MO755N

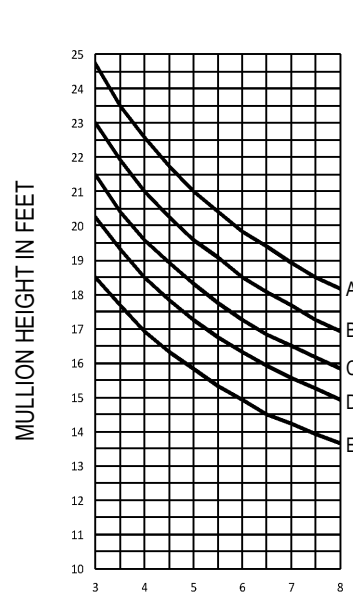

$I = 26.997 \text{ IN}^4$

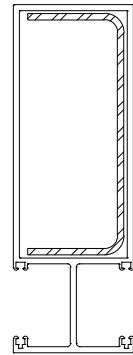

MO755N WITH STEEL REINFORCEMENT
2" X 5" X 10 GA.

- Mullions are assumed to be single span, simple beam elements, uniformly loaded and adequately braced to prevent lateral-torsional buckling. All other complex design conditions shall be reviewed by Arcadia or a design professional.
- Aluminum extrusions shall be 6063-T6 alloy. Allowable stresses to be derived per Aluminum Design Manual. Deflection limitation of mullions shall be in accordance with AAMA TIR-A11 of L/175 for spans up to 13'-6" and L/240 + 1/4" for all others where L is equal to the span of mullion.
- A design professional shall be consulted to confirm that no lite of glass deflects more than H/175 or 3/4", whichever is less, where H indicates the height of glass.
- For mullions containing steel reinforcement, the reinforcement is assumed to be installed for the full length of the mullion. A design professional shall be consulted for instances where steel reinforcement is installed for a partial length of the mullion span.
- Windload pressure determinations shall be per ASCE 7 and according to local governing codes. A professional engineer shall be consulted for the most current laws and local building codes.
- Selection of perimeter fasteners and attachment of glazing system to building structure are project specific and therefore shall be reviewed and determined by a design professional.
- Arcadia assumes no responsibility for selecting the appropriate systems for specific projects.

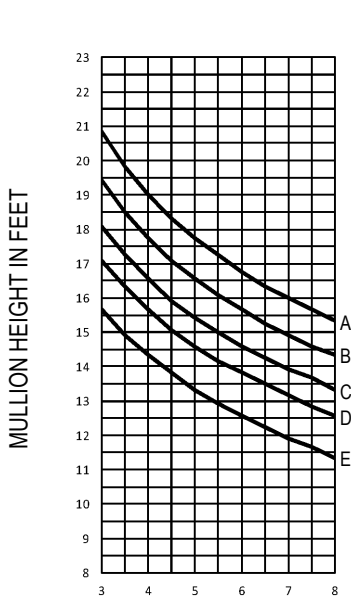

$I = 15.625 \text{ IN}^4$
 $S = 4.159 \text{ IN}^3$

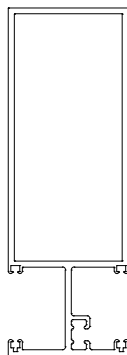

TH755

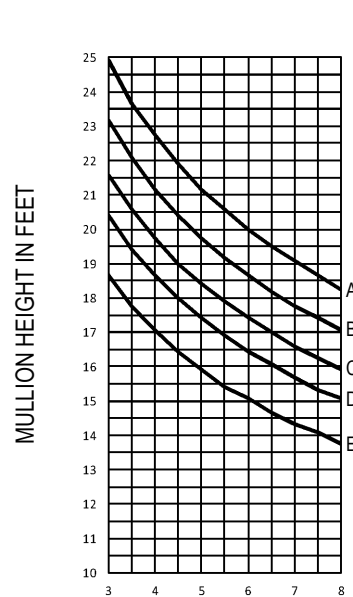

$I = 27.593 \text{ IN}^4$

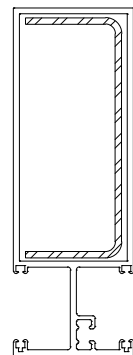

TH755 WITH STEEL REINFORCEMENT
2" X 5" X 10 GA.

Consult Your Local Arcadia Representative For Special Applications Not Covered By These Curves.

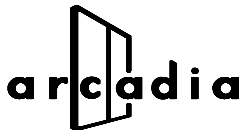

Windload Charts | AFG7251 Series

A = 16 P.S.F. (766 Pa) Description: 2 1/2" X 7 1/4" Offset Glazed For 1" Glass
 B = 20 P.S.F. (958 Pa) Function: Window Wall
 C = 25 P.S.F. (1197 Pa) Detail: Design Criteria
 D = 30 P.S.F. (1436 Pa) Scale: N.T.S.
 E = 40 P.S.F. (1915 Pa)

SHEET 2 OF 3

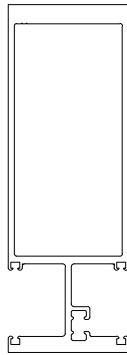
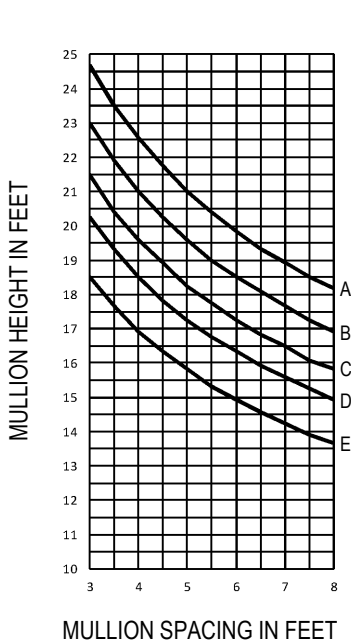

TH758

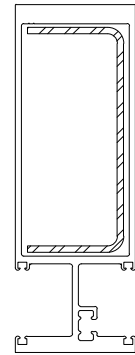
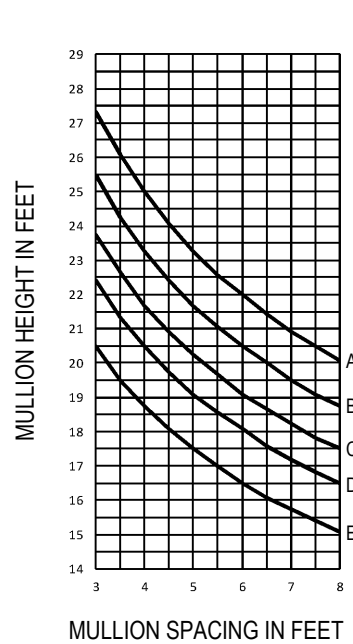

TH758 WITH
STEEL REINFORCEMENT
2" X 4 11/16" X 10 GA.

- Mullions are assumed to be single span, simple beam elements, uniformly loaded and adequately braced to prevent lateral-torsional buckling. All other complex design conditions shall be reviewed by Arcadia or a design professional.
- Aluminum extrusions shall be 6063-T6 alloy. Allowable stresses to be derived per Aluminum Design Manual. Deflection limitation of mullions shall be in accordance with AAMA TIR-A11 of L/175 for spans up to 13'-6" and L/240 + 1/4" for all others where L is equal to the span of mullion.
- A design professional shall be consulted to confirm that no lite of glass deflects more than H/175 or 3/4", whichever is less, where H indicates the height of glass.
- For mullions containing steel reinforcement, the reinforcement is assumed to be installed for the full length of the mullion. A design professional shall be consulted for instances where steel reinforcement is installed for a partial length of the mullion span.
- Windload pressure determinations shall be per ASCE 7 and according to local governing codes. A professional engineer shall be consulted for the most current laws and local building codes.
- Selection of perimeter fasteners and attachment of glazing system to building structure are project specific and therefore shall be reviewed and determined by a design professional.
- Arcadia assumes no responsibility for selecting the appropriate systems for specific projects.

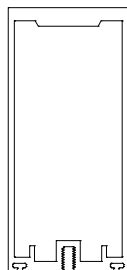
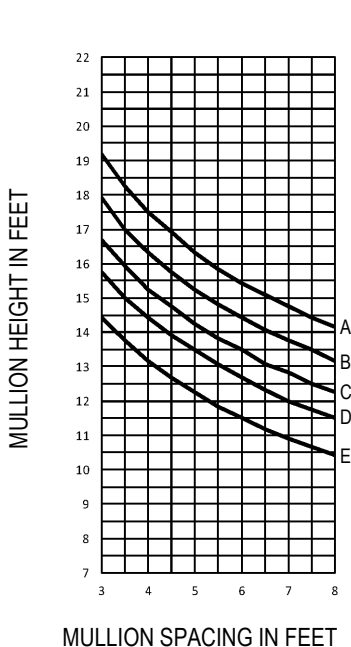

SM765

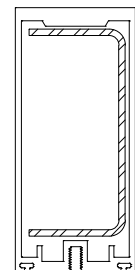
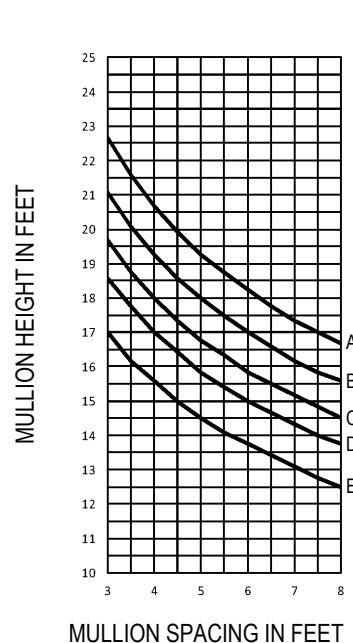

SM765 WITH
STEEL REINFORCEMENT
2" X 4 5/16" X 10 GA.

Consult Your Local Arcadia Representative For Special Applications Not Covered By These Curves.

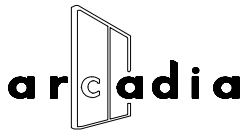

Windload Charts | AFG7251 Series

A = 16 P.S.F. (766 Pa) Description: 2 1/2" X 7 1/4" Offset Glazed For 1" Glass
 B = 20 P.S.F. (958 Pa) Function: Window Wall
 C = 25 P.S.F. (1197 Pa) Detail: Design Criteria
 D = 30 P.S.F. (1436 Pa) Scale: N.T.S.
 E = 40 P.S.F. (1915 Pa)

SHEET 3 OF 3

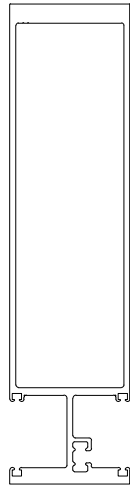
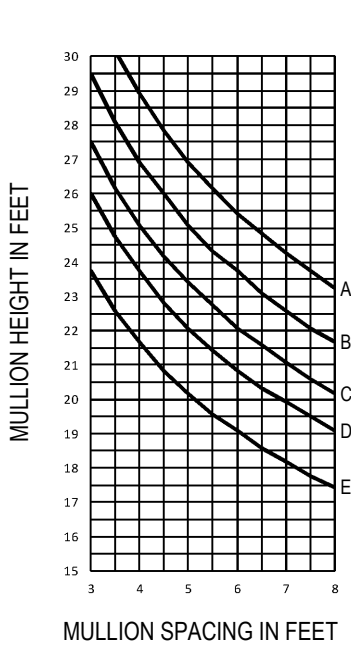

TH1058

- Mullions are assumed to be single span, simple beam elements, uniformly loaded and adequately braced to prevent lateral-torsional buckling. All other complex design conditions shall be reviewed by Arcadia or a design professional.
- Aluminum extrusions shall be 6063-T6 alloy. Allowable stresses to be derived per Aluminum Design Manual. Deflection limitation of mullions shall be in accordance with AAMA TIR-A11 of L/175 for spans up to 13'-6" and L/240 + 1/4" for all others where L is equal to the span of mullion.
- A design professional shall be consulted to confirm that no lite of glass deflects more than H/175 or 3/4", whichever is less, where H indicates the height of glass.
- For mullions containing steel reinforcement, the reinforcement is assumed to be installed for the full length of the mullion. A design professional shall be consulted for instances where steel reinforcement is installed for a partial length of the mullion span.
- Windload pressure determinations shall be per ASCE 7 and according to local governing codes. A professional engineer shall be consulted for the most current laws and local building codes.
- Selection of perimeter fasteners and attachment of glazing system to building structure are project specific and therefore shall be reviewed and determined by a design professional.
- Arcadia assumes no responsibility for selecting the appropriate systems for specific projects.

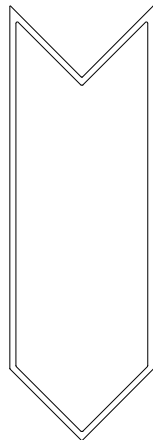
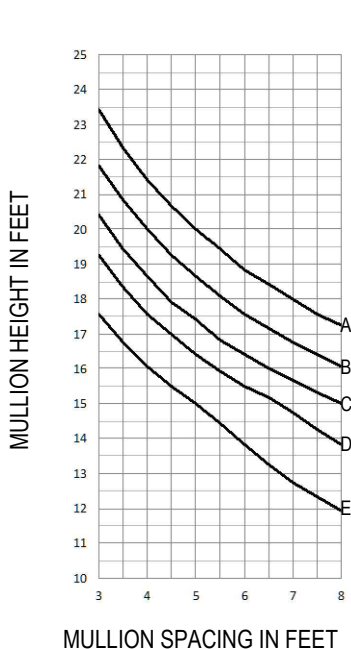

ICOC904

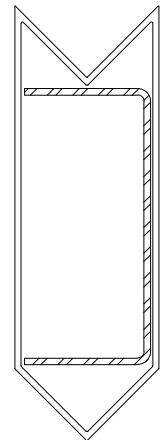
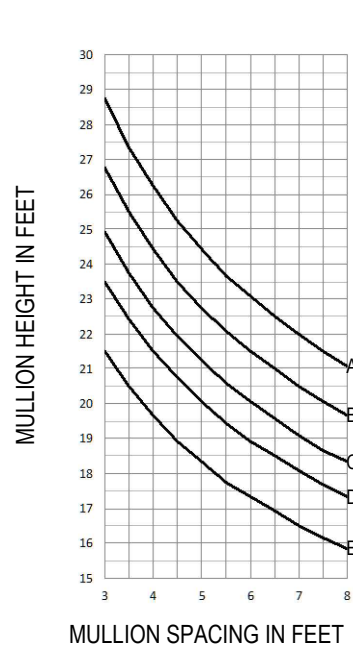

ICOC904 WITH STEEL REINFORCEMENT
2 5/8" X 5 3/4" X 10 GA.

Consult Your Local Arcadia Representative For Special Applications Not Covered By These Curves.

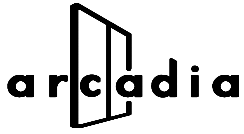

Deadload Charts | AFG7251 Series

Description: 2 1/2" X 7 1/4" Offset Glazed for 1" Glass

Function: Window Wall

Detail: Design Criteria

Scale: N.T.S.

Deadload Charts for 1" Glass (7.00 PSF)

SHEET 1 OF 1

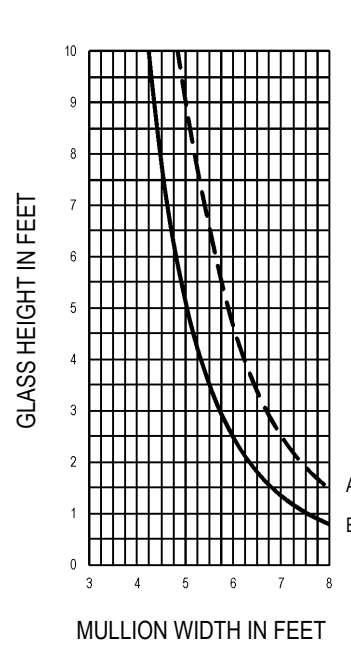
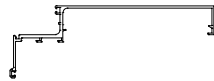
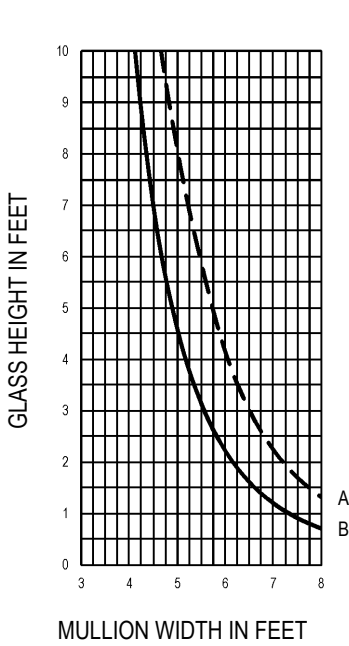

CURVE REPRESENTATION
 A (----) = 1/8" PTS.
 B (—) = 1/4" PTS.