

Center Glazed

Side Load

ASL451 Series

Description: 2" x 4 1/2" Center Glazed for 1" Glass

Function: Storefront

Detail: Horizontals

Scale: 3" = 1'-0"

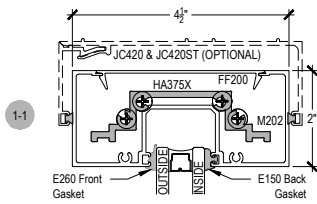

1-1

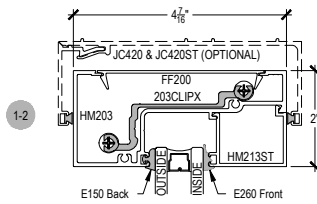

1-2

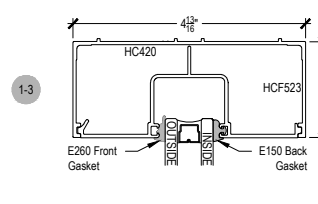

1-3

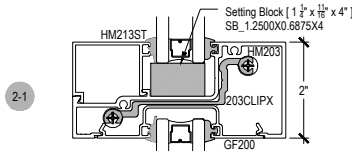
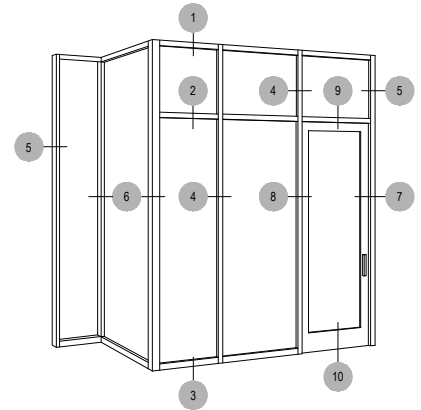

2-1

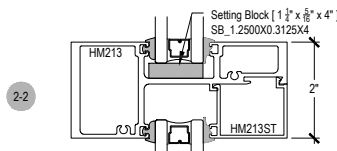

2-2

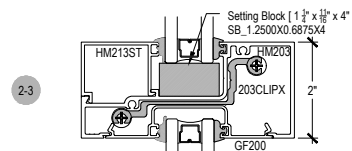

2-3

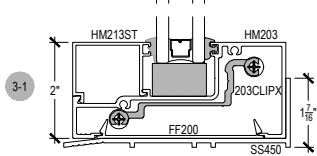

3-1

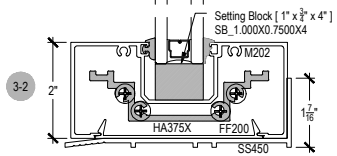

3-2

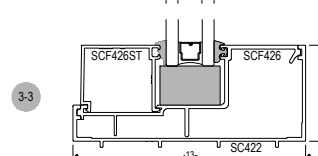

3-3

SHEAR BLOCK
OUTSIDE SET

SHEAR BLOCK
INSIDE SET

COMPENSATING STICK
OUTSIDE SET

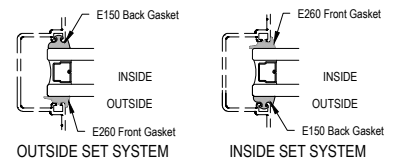

OUTSIDE SET SYSTEM INSIDE SET SYSTEM

GASKET PLACEMENT
FOR INSIDE/OUTSIDE
SET SYSTEMS

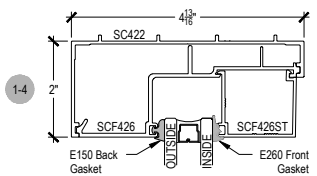

1-4

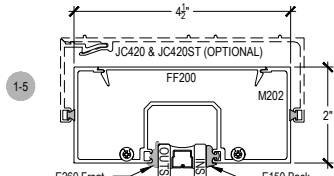

1-5

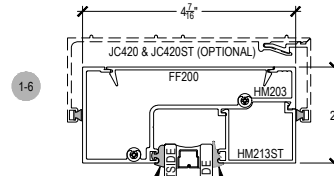

1-6

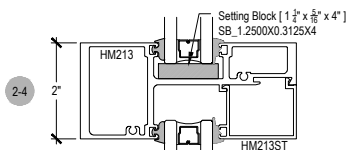

2-4

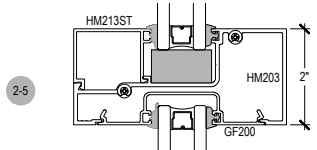

2-5

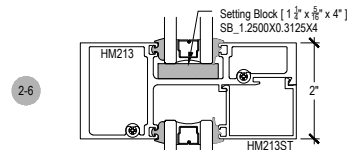

2-6

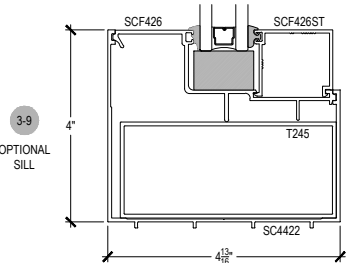

3-9
OPTIONAL
SILL

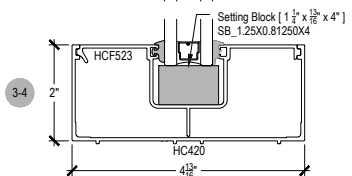

3-4

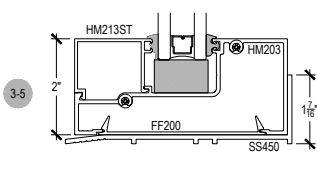

3-5

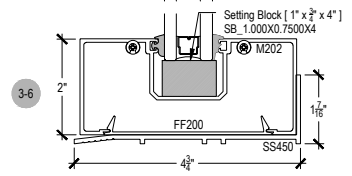

3-6

COMPENSATING STICK
INSIDE SET

SCREW SPLINE
OUTSIDE SET

SCREW SPLINE
INSIDE SET

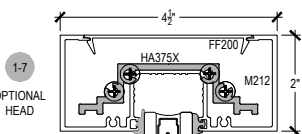

1-7
OPTIONAL
HEAD

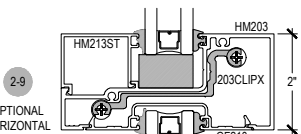

2-9
OPTIONAL
HORIZONTAL

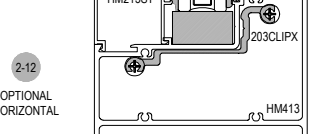

2-12
OPTIONAL
HORIZONTAL

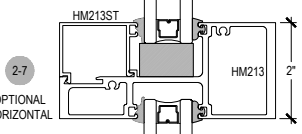

2-7
OPTIONAL
HORIZONTAL

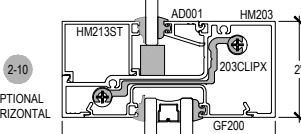

2-10
OPTIONAL
HORIZONTAL

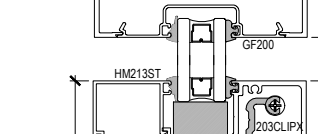

3-7
OPTIONAL
SILL

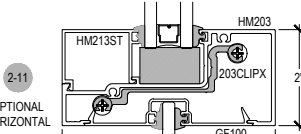

2-11
OPTIONAL
HORIZONTAL

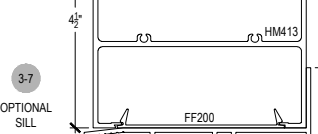

3-8
OPTIONAL
SILL

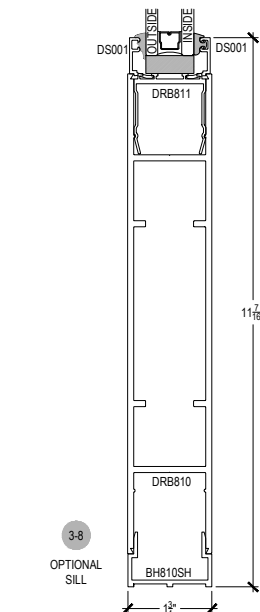

3-8
OPTIONAL
SILL

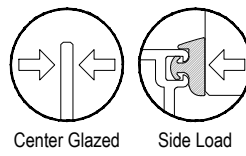

ASL451 Series

Description: 2" x 4 1/2" Center Glazed for 1" Glass

Function: Storefront

Detail: Verticals

Scale: 3" = 1'-0"

SHEET 2 OF 3

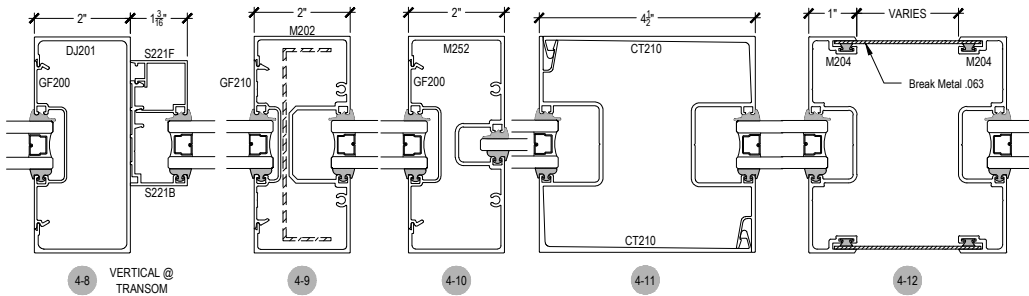
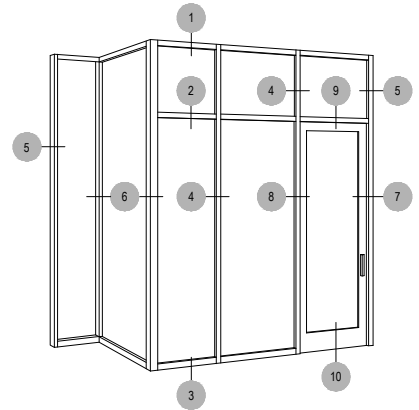
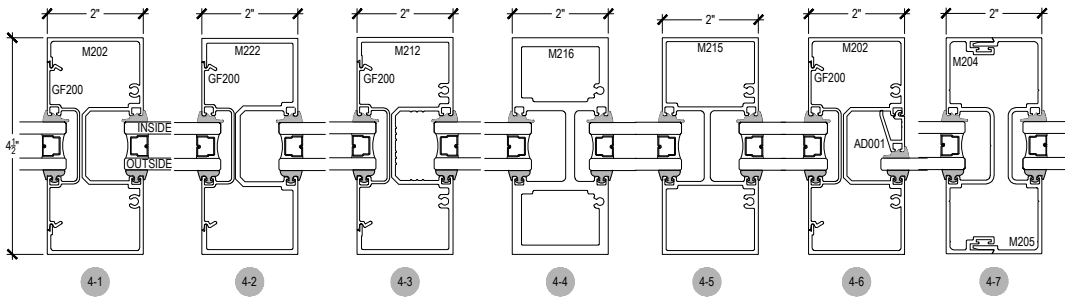

GASKET PLACEMENT FOR 1 1/4" POCKET

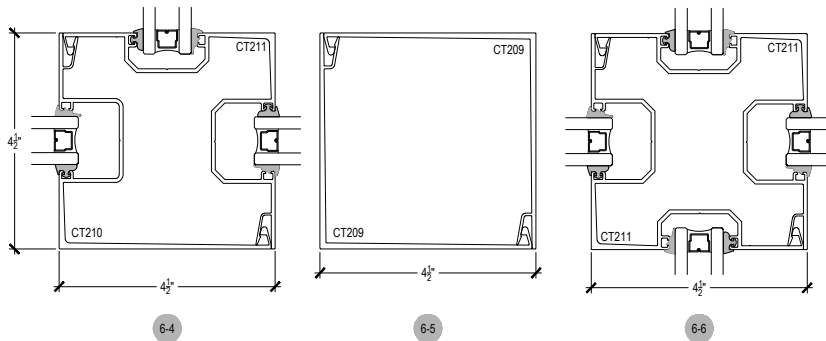
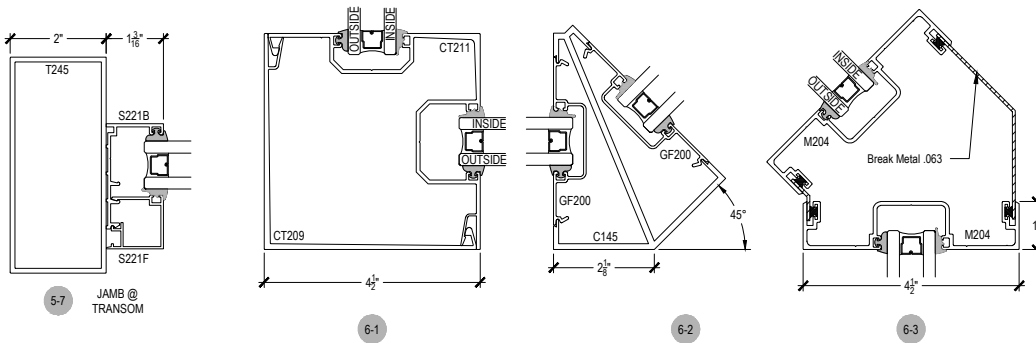
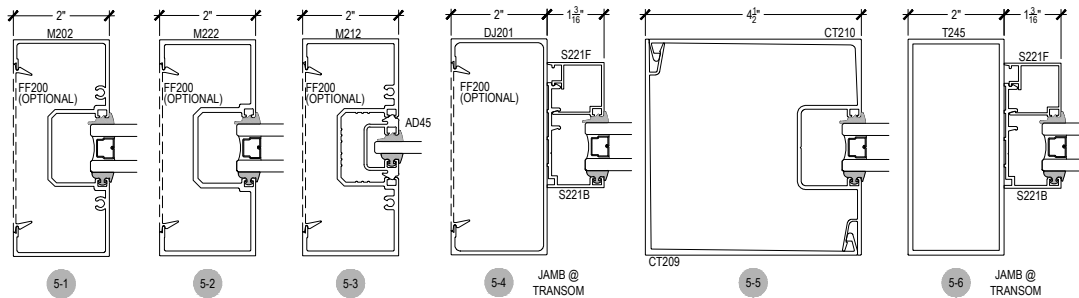
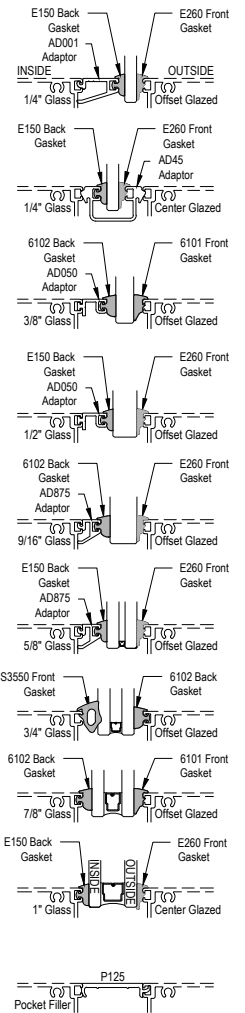

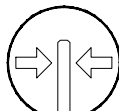

Center Glazed

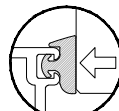

Side Load

ASL451 Series

Description: 2" x 4 1/2" Center Glazed for 1" Glass

Function: Storefront

Detail: Verticals

Scale: 3" = 1'-0"

SHEET 3 OF 3

